

ORDINANCE NO. 82-21

ORDINANCE AUTHORIZING THE CONSOLIDATION OF "KENDALE LAKES AND KENDALE LAKES SOUTH LANDSCAPE MAINTENANCE SPECIAL TAXING DISTRICTS" IN ACCORDANCE WITH THE PROVISIONS OF SECTION 18-16 OF THE DADE COUNTY CODE; AND PROVIDING AN EFFECTIVE DATE.

WHEREAS, the Dade County Parks and Recreation Department has requested the consolidation of the Kendale Lakes and Kendale Lakes South landscape maintenance special taxing districts based on the facts and for the purpose described more fully in the attached memorandum from William Powell, Director of the Public Works Department, to the County Manager; and

WHEREAS, the Board is authorized and empowered by Section 18-16(i), Code of Metropolitan Dade County, to consolidate any two or more special taxing districts of the same classification created and established under the provisions of Article I, Chapter 18 of the Code; and

WHEREAS, a cost comparison prepared by the Dade County Parks and Recreation Department indicates that the maintenance programs of the subject districts are identical and that the cost for services per mile is nearly identical; and

WHEREAS, the Parks and Recreation Department, the Public Works Department and the County Manager's Office concur in the recommendation in favor of the consolidation, and there appear to be no objections to said consolidation; and

WHEREAS, neither the Kendale Lakes nor the Kendale Lakes South landscape maintenance special taxing districts have any bonds outstanding,

NOW, THEREFORE, BE IT ORDAINED BY THE BOARD OF COUNTY COMMISSIONERS OF DADE COUNTY, FLORIDA:

Section 1. That the foregoing recitations are hereby incorporated herein as a portion of this ordinance.

Section 2. That this Board approves the consolidation
of the Kendale Lakes and Kendale Lakes South landscape
maintenance special taxing districts.

Section 3. This ordinance shall become effective ten
(10) days after the date of its enactment.

PASSED AND ADOPTED: MAR 16 1982

Approved by County Attorney as to
form and legal sufficiency. RAG

Prepared by: Ry

MEMORANDUM

107.07-17A

TO M. R. Stierheim
County Manager
ATTN: Dennis I. Carter
Assistant County Manager

DATE February 19, 1981

FROM *William M. Powell*
William M. Powell, Director
Public Works Department

SUBJECT Consolidation of Kendale Lakes
and Kendale Lakes South Land-
scape Maintenance Special Taxing
District

A request has been submitted to the Dade County Public Works Department from the Dade County Parks & Recreation Department, requesting the consolidation of the subject landscape maintenance special taxing districts. "Kendale Lakes" was created and established on July 17, 1973, by Resolution No. R-923-73 and "Kendale Lakes South" was created and established on December 12, 1978, by Ordinance No. 78-93. The above cited existing landscape maintenance districts were passed and adopted by the Board of County Commissioners in accordance with the requirements of Article I, Chapter 18 of the Code of Metropolitan Dade County, Florida.

Under Section 18-16(1) of the Code, the Board is authorized and empowered to consolidate any two or more special taxing districts of the same classification created and established under the provisions of this article.

As Public Works Director, responsible for the detailed investigation of such requests, the following facts are hereby submitted concerning the consolidation of the "Kendale Lakes Landscape Maintenance Special Taxing District" and the "Kendale Lakes South Landscape Maintenance Special Taxing District". The proposed consolidation entity is to be called the "Kendale Landscape Maintenance Special Taxing District" and herein after called the District.

1. BOUNDARIES OF THIS DISTRICT

The districts to be consolidated are located entirely within unincorporated Dade County, Florida. The boundaries of the District are as follows:

All of Section 27, Township 54 South, Range 39 East, Dade County, Florida; less and excepting therefrom Tracts A, B and G of "Kendale Lakes North Section One", recorded in Plat Book 93, at Page 1, of the Public Records of Dade County, Florida;

AND

Tracts 1 thru 16, Tract 18, Tracts 29 thru 36, Tracts 45 thru 56, and Tracts 61 thru 64 of "A. J. Bendle Subdivision", recorded in Plat Book 1, at Page 30, of the Public Records of Dade County, Florida;

AND

All of Section 34, Township 54 South, Range 39 East, of Dade County, Florida;

LESS

All of Tract H of "Kendale Lakes Section 6", recorded in the Public Records of Dade County, Florida.

The boundaries are as shown on the attached plan entitled "Kendale Landscape Maintenance Special Taxing District".

2. LOCATION OF THE SERVICES TO BE PROVIDED

The services currently being provided within the subject districts consist of a maintenance program to avoid excessive growth and accumulation of weeds, undergrowth and other plant life so as to avoid infestation by animals and insects which may adversely affect and impair the economic welfare of adjacent developed properties.

The areas being maintained consist of swale and center medians within and adjacent to the road rights-of-way.

3. ESTIMATED COST FOR THIS SERVICE

A cost comparison prepared by the Dade County Parks & Recreation Department indicates that the maintenance programs of the subject districts are identical and that the cost for services per mile is nearly identical. (See attached memorandum.)

4. RECOMMENDATION CONCERNING THE DESIRABILITY OF THIS CONSOLIDATION

The proposed consolidation of the subject districts is economically and administratively needed and desirable and, in my opinion, the consolidation will provide special benefits to both the district and Dade County without affecting current service and special assessment levels.

5. ESTIMATE OF ASSESSMENT AGAINST BENEFITTED PROPERTY

The cost of the landscape maintenance program is paid solely by special assessments levied against all properties within the subject districts and is apportioned to individual properties on the basis of lot or parcel square footage.

The cost per square foot currently assessed is \$.002242 for both districts and no additional assessments, burdens, or liabilities will be placed on the property owners of either district as a result of this consolidation.

6. RECOMMENDATION

I recommend that this consolidation request be processed pursuant to Section 18-16(1) of the Code. No referendum is required as neither the level of service nor the rate of assessment will be changed in either district. I further recommend that the County Attorney cause to be prepared an ordinance authorizing the consolidation of the subject districts described herein containing such specifications as are required by Section 18-16(i) to be presented before the Board. The Board pursuant to Section 18-16(i) of the Code shall receive and hear at a public hearing objections, of interested parties, to this consolidation and any defects in the proceedings and thereafter may adopt such ordinance.

WMP:CWS:jw

Attachments

PROPOSED DISTRICT BOUNDARIES

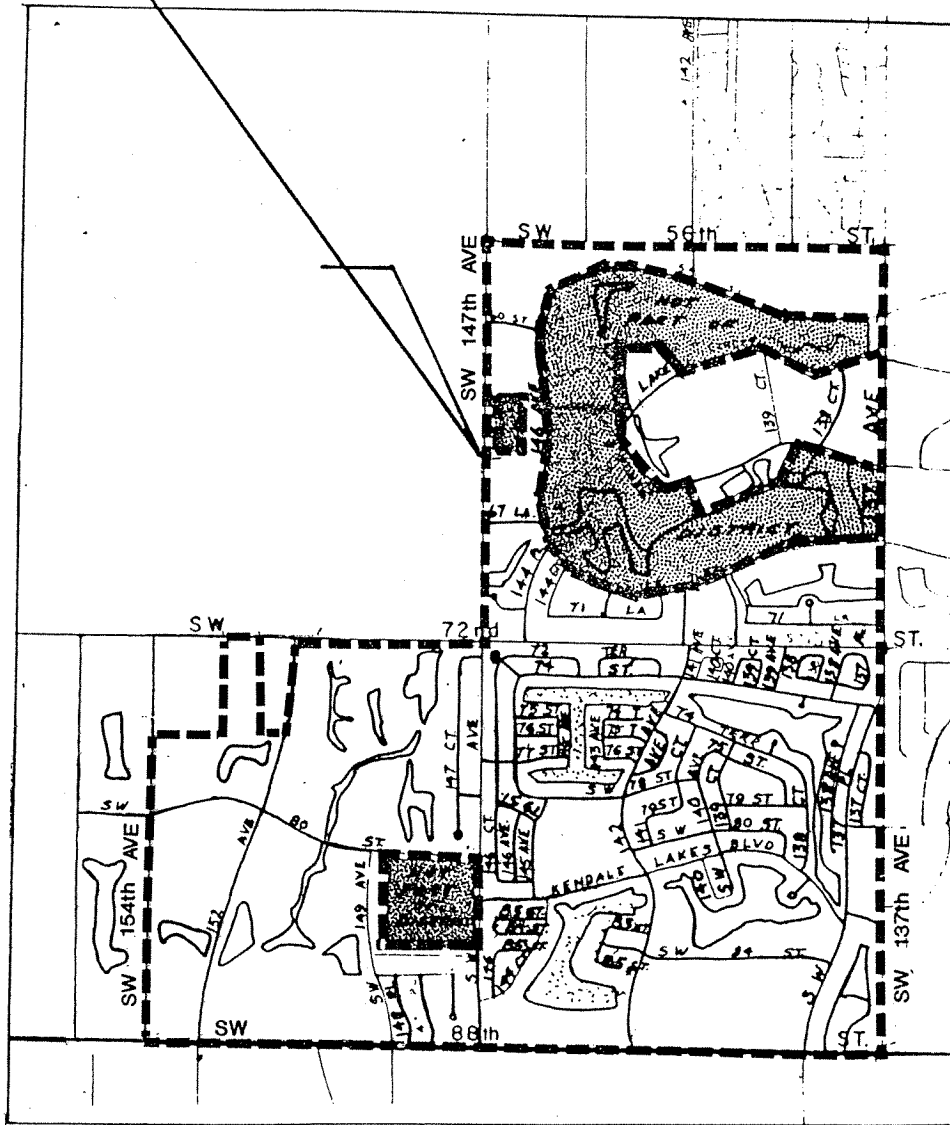

KENDALE LANDSCAPE MAINTENANCE SPECIAL TAXING DISTRICT (CONSOLIDATION)

SECTION: 27, 33, 34-54-39

Exhibit "B"